



**FLOOR
PLAN**
LEVEL 3: TYPE G

elysian
ELEVATED BEACH LIFE

ABOUT THE DEVELOPMENT

Located at 185 Old Burleigh Road, Broadbeach, *elysian* offers exceptional beachfront and hinterland views from each of its 65 apartments. Limited to 4 dwellings per floor, *elysian* stands as a tribute to harmonious aesthetics inspired by its natural surroundings and urban conveniences.

From the masterfully finished interiors, through to a virtual concierge and very latest in automated underground car parking, everything has been designed to connect you to the *elysian* way, elevated beyond anything of this world.

APARTMENT FINISHES

- Built-in SMEG appliances
- Modern-luxe styling that features premium imported stone on the benchtop and splashback
- Engineered timber flooring throughout living and dining
- Feature pendant lights
- Bespoke tapware

APARTMENT FEATURES

- Ocean views
- Full-height glazing
- Open-plan living flanked by bedrooms on either side
- Dual access to balcony
- Main bathroom with dual access
- Separate laundry
- Both bedrooms with walk-in-robos

BUILDING FACILITIES

- Sauna Room
- Dining Areas
- Swimming Pool
- Gymnasium / Yoga Studio
- Washroom and Lavatory
- Hercules Carparking System
- My Butler Virtual Concierge

[ELYSIANBROADBEACH.COM.AU](https://elysianbroadbeach.com.au)

185 OLD BURLEIGH ROAD, BROADBEACH | 1300 135 550 | LIVE@ELYSIANBROADBEACH.COM.AU

elysian is not yet built and aspects of the design may change. This document reflects the Developer's current intentions only and the final product may differ from that depicted in this document due to regulatory, design, engineering and other reasons. Buyers should refer to the final disclosure document and contract documentation. The content of this document is correct to the best of the Developer's knowledge, but no warranty is given or representation made that it is accurate or complete.

FLOOR PLAN

2  2  1 

LEVEL 3
APARTMENT 303
TYPE G

INTERNAL AREA 71m²
EXTERNAL AREA 22m²
TOTAL AREA 93m²

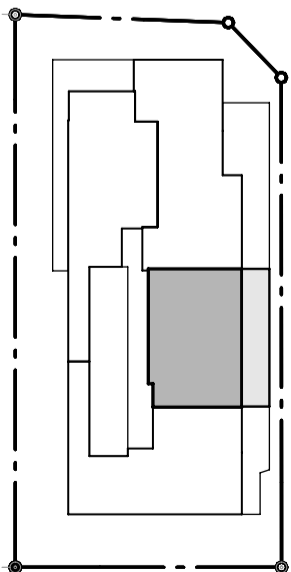

elysian
ELEVATED BEACH LIFE

SPYRE
GROUP

IMPORTANT, PLEASE READ CAREFULLY. All dimensions, floor areas, fittings, specifications, floor finishes, images and diagrams are indicative only and subject to change without notice. Furnishings, accessories and whitegoods not included. Finished product may differ from that depicted. Landscaped area does not form part of the apartment area and is not accessible from the apartment. Interested persons should carefully check plans in the contract and associated documents and make their own enquiries and rely on their own investigations and advice.